

Vertical Clamp E type

Model	E1-20	E2-30	E3-35	E5-45	E7-50	E10-50
Capacity (tonnes)	1	2	3	5	7	10
Jaw Opening (mm)	0-20	0-30	0-35	0-45	0-50	0-50
Dimensions (mm)	A	23	34	40	50	55
	B	28	42	44	57	92
	C	125	165	175	218	286
	F	155	190	225	260	345
	G	50	58	60	65	70
	H	260	304	362	416	510
	I	50	60	76	90	107
J	14	17	18	20	25	30
Net Weight (kg)	3.8	6.0	9.3	18.5	33.0	48.5

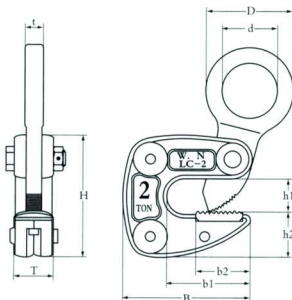

Horizontal Clamp HLC Type

Model	HLC1	HLC2	HLC3
Capacity (tonnes)	1	2	3
Clamping Range (mm)	1-13	3-22	12-35
Dimensions (mm)	B	105	137
	b1	66	87
	b2	44	58
	D	72	96
	d	46	61
	H	104	130
	h1	24	36
h2	40	50	67.5
T	32	42	52
t	14	18	23
Net Weight (kg)	1.6	3.9	8.9



Ratchet Puller WRP Type

Model	WRP1000	WRP 1500	WRP 2000
Capacity (tonnes)	1	1.5	2
Max. Lift (mm)	1210	1400	1400
Min. Lift (mm)	410	480	480
Wire Rope Dia. (mm)	5	6	6
Wire Rope Length (mm)	2300	2300	2300
Net Weight (kg)	3.2	4.2	4.5



Cable Grip JCG Type

Model	JCG500	JCG1000	JCG2000	JCG3000
Capacity (tonnes)	0.5	1	2	3
Wire Rope Dia. (mm)	1.0~10	2.6~15	4.0~22	16~32
Net Weight (kg)	0.4	0.7	1.3	2.4